

Swegon Home Solutions

CASA[®] duct coils for cooling the supply air



WATERBORNE COOLING DUCT COILS

Duct coils for installation in the supply air duct, for cooling the supply air.

The lowest coil height is only 255 mm, which permits installation in a suspended ceiling.

Meets demands for leakage class C.

The control mode and settings can be changed using a CASA Smart control panel.



Ventilation unit Swegon CASA W3/R3

SDCW 16033W LVI-no 7906555

Ventilation unit Swegon CASA W4/R5

SDCW 20033W LVI-no 7906556

Ventilation unit Swegon CASA W5/R5/W9

SDCW 250K3W LVI-no 7906557

CASA comfort cooling

Included in the delivery:

- Cooling duct coil
- Actuators and valves
- Requisite sensors
- Instructions

Three standard sizes:

- Duct connections with rubber seals for round ventilation ducts.
- Galvanized sheet steel casing.
- Openable hatch for inspection and cleaning.
- Drip tray for condensate
- (CWK G1/2", W2504F G3/8")
- Air tightness class corresponds to class C according to standard EN 15727.
- Maximum operating temperature 150 degrees.
- Maximum operating pressure 1.0 MPa (10 bar.)
- Fully insulated 250 mm cooling duct coil, wall mounting bracket/ceiling mounting frame included, also equipped with a coarse filter.

Accessories:

- Condensate hose W2504F for cooling duct coil: 502130

Three different sized cooling duct coils for the supply air duct:

- For 160 mm ducts; SDCW 16033W (LVI-no 7906555)

The following components are included in the delivery:

- CASA CWK 160-3-2.5 cooling duct coil
- 3-way valve (1/2", kvs 0.6) Belimo R3015-P63-S1
- Actuator Belimo HRYD24-SR
- Temperature sensor, cable length 3 m.

- For 200 mm ducts; SDCW 20033W (LVI-no 7906556)

The following components are included in the delivery:

- CASA CWK 200-3-2.5 cooling duct coil
- 3-way valve (1/2", kvs 0.6) Belimo R3015-P63-S1
- Actuator Belimo HRYD24-SR
- Temperature sensor, cable length 3 m.

- For 250 mm ducts; SDCW 25033W (LVI-no 7906557)

The following components are included in the delivery:

- CASA W2504F duct chiller, fully insulated
- 3-way valve (1/2", kvs 1.0) Belimo R3015-1-S1
- Actuator Belimo HRYD24-SR
- Temperature sensor, cable length 3 m.
- Wall mounting bracket/ceiling mounting frame

Function

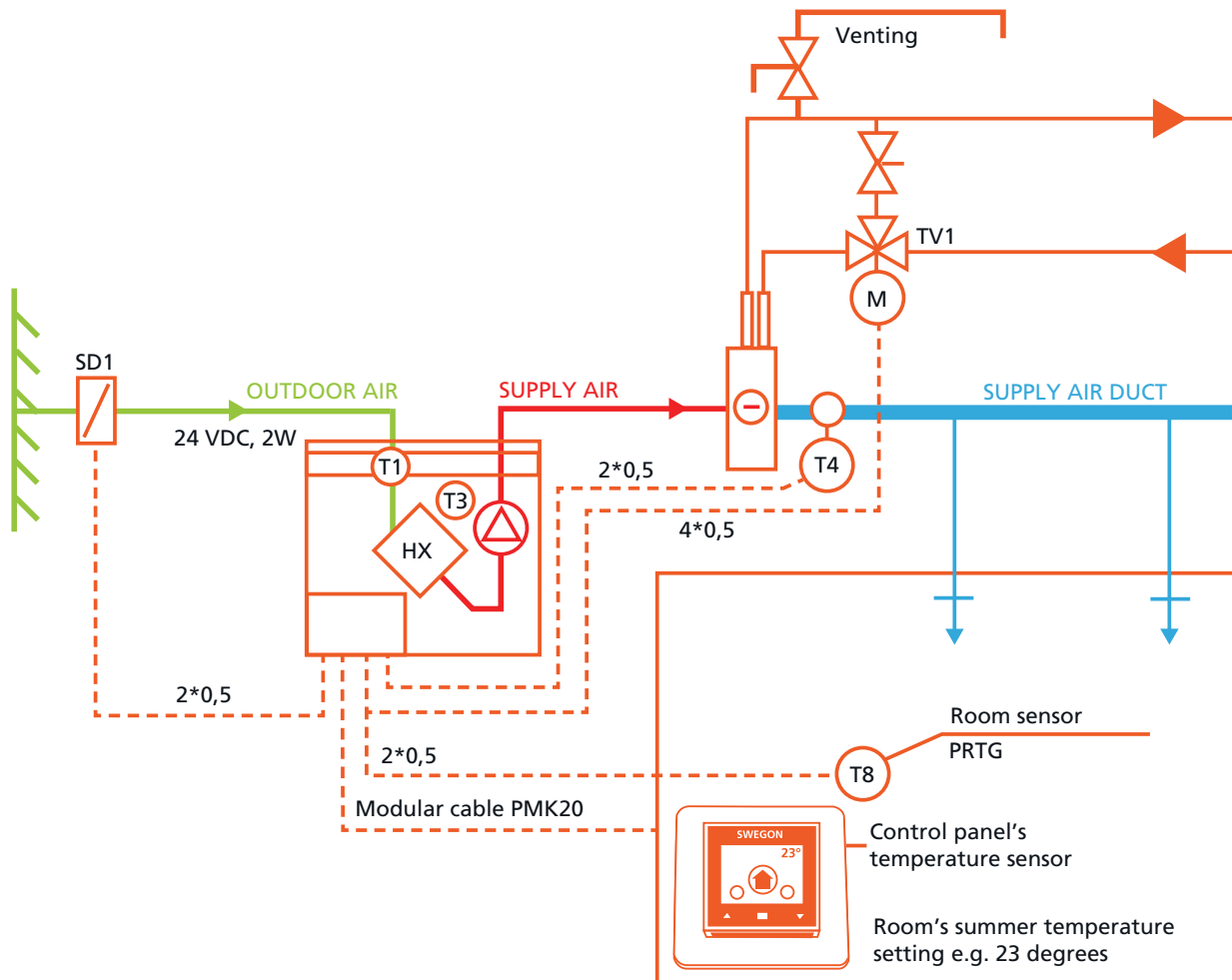

The function of the duct coil is controlled from a control panel via an adjustable room temperature setting. Valve TV1 is controlled by the room temperature, according to the options:

1. By a temperature sensor comprised by a CASA Smart control panel.
2. By a separate room temperature sensor T8 (accessory).
3. By unit's internal extract air temperature sensor T3.
4. With standard setting for the supply air based on the T4 sensor.

Operating release for cooling is given based on the CASA ventilation unit's internal outdoor temperature sensor T1. The temperature after cooling T4, can, for example, be read on a Smart panel.

The following applies to the ventilation unit and system:

- Unit equipped with a Smart control system
- Smart control panel with 20 m long modular cable
- At least one, in the outside air duct positioned shut-off damper SD1, control signal is obtained from the circuit board 24 VDC, max. 2 W
- Heating and/or condensation insulation of the supply air duct coil and condensate pipe
- Venting of the pipe system
- Balancing of the pipe system/coil
- Not compatible with the Econo models

CASA cooling coils for the supply air duct:

CASA CWK 160-3-2.5 (chilled water 7/12)				H=255, L=356		
Airflow		Pressure loss for air	Output approximately 26→15	Chilled water	Pressure loss chilled water	The air's flow to the coil
l/s	m³/h	Pa	kW	l/s	kPa	m/s
40	140	9	0.7	0.03	5.62	0.5
55	200	15	0.9	0.04	8.65	1.23
70	250	22	1.1	0.05	11.68	1.57

CASA CWK 200-3-2.5 (chilled water 7/12)				H=330, L=356		
Airflow		Pressure loss for air	Output approximately 26→15	Chilled water	Pressure loss chilled water	The air's flow to the coil
l/s	m³/h	Pa	kW	l/s	kPa	m/s
55	200	5	1	0.05	2.22	0.67
70	250	8	1.3	0.06	4.11	0.85
85	300	11	1.5	0.07	5.59	1.04
100	360	15	1.7	0.08	6.96	1.22
115	410	19	1.8	0.09	8.32	1.4

CASA W2504F (chilled water 7/12)				H=350, L=479		
Airflow		Pressure loss for air	Output approximately 26→15	Chilled water	Pressure loss chilled water	The air's flow to the coil
l/s	m³/h	Pa	kW	l/s	kPa	m/s
60	216	13	1,0	0,05	3,2	0,67
70	252	15	1,0	0,05	3,2	0,78
90	324	22	1,1	0,06	3,7	1,00
100	360	26	1,2	0,06	4,0	1,11
150	540	44	1,4	0,07	4,6	1,67

Other sizes are available, please ask for sizing data separately

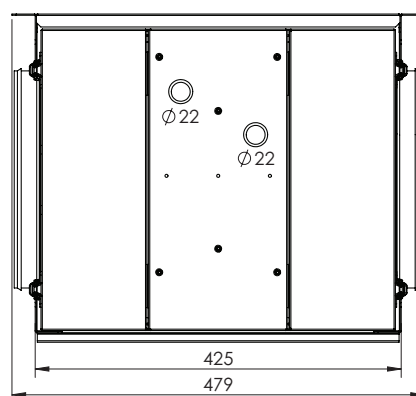
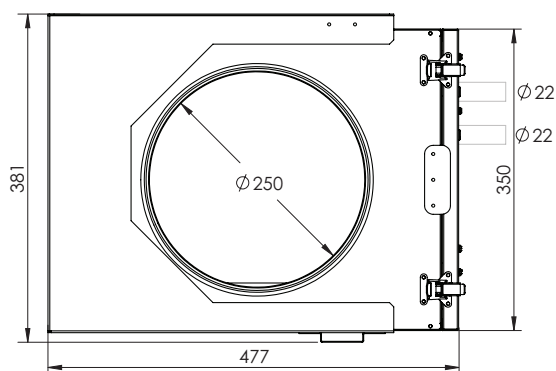

W2504F

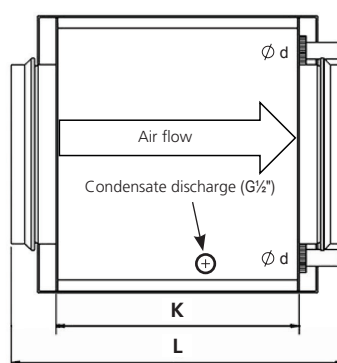
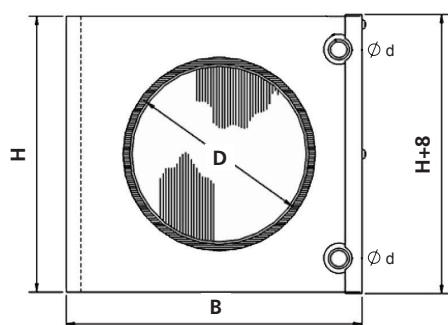

CWK 160

H: 255 mm
B: 326 mm
D: 160 mm
d: 10 mm

K: 276 mm
L: 356 mm

CWK 200

H: 330 mm
B: 411 mm
D: 200 mm
d: 22 mm

K: 276 mm
L: 356 mm

Leave at least 40 cm service space in front of the door.